



Instruction Manual

TORCH WRAP/SPARE PARTS KIT HOLDER POWERCUT-650, 875, 1125 & 1500

PowerCut-650	P/N 0558003398
PowerCut-875 and PowerCut-1125	P/N 0558003013
PowerCut-1500	P/N 0558003059

The Torch Wrap/Spare Parts Kit Holder accessories are designed to provide convenience and protection of the torch cable while providing a handy place to store consummables and tools. The kit can be attached to either side of the PowerCut Console.

Assemble as follows:

1. Remove the 1/4"-20 thread forming screw on one side (left or right, your choice) of both ends of the middle plastic handle cover.
2. Mount the two Handle mounting brackets to each handle located in the same holes where

- the bolts were removed in step one. Use two spacers (0558002271), two 1/4" bolts and lockwashers supplied.
3. Secure the Enclosure mounting bracket to the two handle mounted brackets by sliding the bracket over the four 1/4" studs and attaching four lockwashers and nuts supplied (Step 3 not needed for Powercut-650).
4. Mount the spare parts kit enclosure by sliding the two slots together located on the rear (opposite door) of the enclosure and middle of the bracket mounted in step 3. The two are locked in place when the bottom of the slots meet.

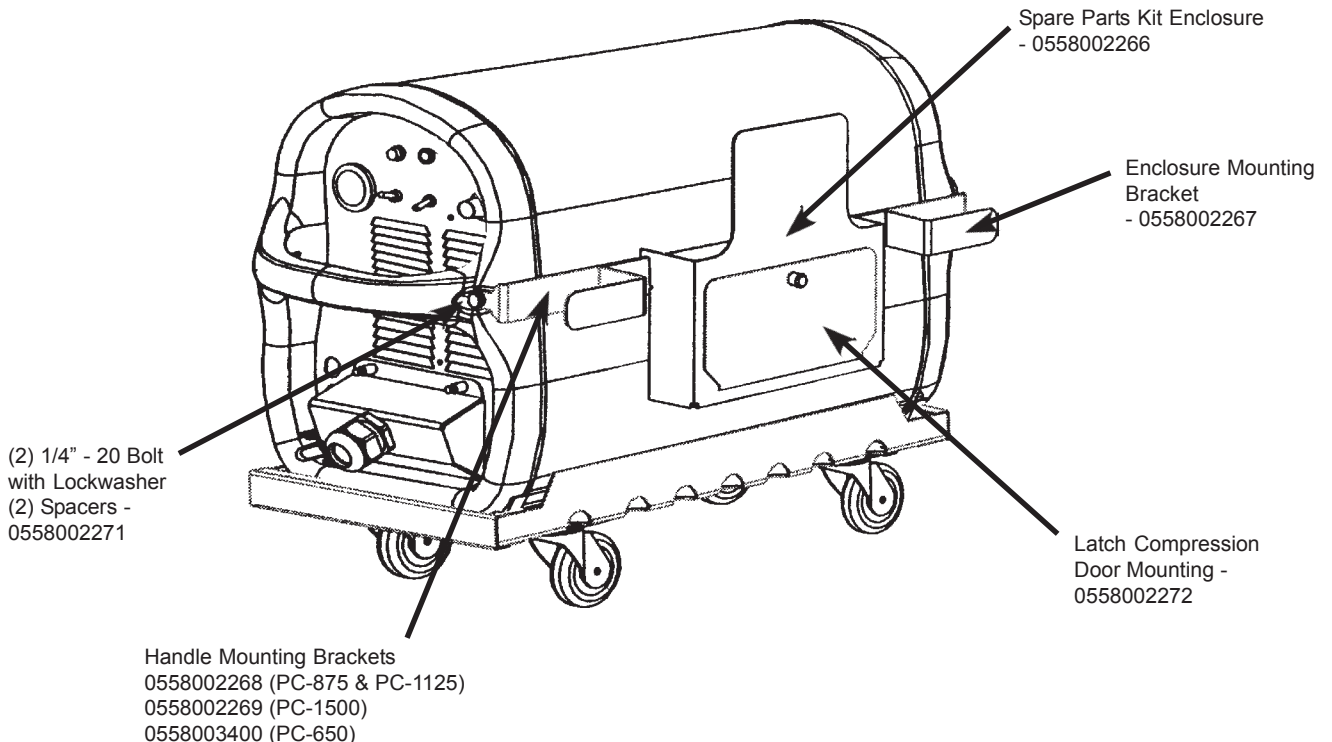

**Be sure this information reaches the operator.
You can get extra copies through your supplier.**



ESAB® ESAB Welding & Cutting Products
PO Box 100545, Florence SC 29501-0545